



Dane View

A development of new **two** and **three bedroom shared ownership homes** in Northwich



prospa
HOMES





Welcome to Dane View

Prosopa Homes is delighted to offer a range of shared ownership homes at Dane View. This brand new Barratt Homes development is situated on the outskirts of Northwich, Cheshire and offers a suburb opportunity to buy a brand new home, at a price you can afford.

Our Dane View homes are brand new two and three bedroom shared ownership homes in this popular Cheshire town. With 3-bed 'Roxby' and 2-bed 'Whitby', there is a home to suit you. These homes are available from £70,000; at 50% shared ownership (other percentages are possible). With two more phases due Dec 2019 and June 2020*.

Each home is built to Barratt Homes' high specification and with a high end interiors including fully fitted Symphony kitchens, turfed gardens, private driveway parking, these homes are not to be missed.

Dane View

Dane View is situated on the outskirts of Northwich. The town is steeped in history and lies in the heart of the Cheshire Plain, where the two rivers Weaver and Dane meet.

The area has been mined for salt since Roman times and still is to this day, with Lion Salt Works voted the UK's Best Heritage Project in 2018. The recent developments at Barons Quay, including a new cinema and shopping development have added to this thriving and busy market town and not forgetting the great new leisure facilities, including a swimming pool at Northwich Brio Leisure Centre.

Northwich's shops, including a Waitrose, with restaurants and multiplex cinema are just three miles away. Northwich offers the best of both worlds, with great shops, library and a thriving family-friendly community. Northwich is served by many own primary schools with access to secondary schools in nearby Weaverham and Hartford, along with Sir John Deane's sixth form college in Northwich.

*Prices and dates correct at present time but may be subject to change.

Images for illustrative purposes only, and not to be relied upon or form part of legal contract

Connected

Situated just 24 miles from Manchester and 18 miles from Chester and with easy and quick access to the M6 and M56 via the newly upgraded motorway link road A556, Northwich is an ideal base to live and work.

Manchester Airport is easily reached and there are main train links to Manchester and Liverpool locally.

Surrounded by spectacular places to visit and enjoy such as Marbury Park, Tatton Park and Delamere Forest just a short drive away, meaning Northwich ticks all the boxes.

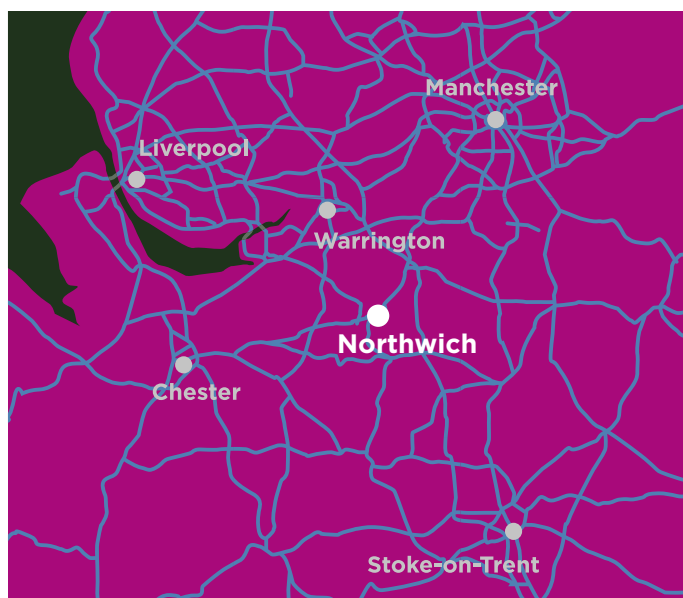



Bespoke Design

10 Year NHBC Warranty for total piece of mind.

Homes designed to be energy efficient, for low running costs.

Designed with great attention to detail to meet the needs of modern living.



Specification

- ✓ Parking – private driveway to front or side of each home, with most homes benefitting from two parking spaces
- ✓ Ground floor WC to every home
- ✓ Double doors/French Window to rear leading to garden.
- ✓ Turf and fencing to rear gardens

- ✓ Kitchens by – Symphony
- ✓ Soft closing units and drawers
- ✓ Kitchen Appliances – integrated oven, hob and extractor hood.... and an integrated Fridge-Freezer
- ✓ Stainless steel splashback
- ✓ Vinyl flooring to kitchen
- ✓ LED downlights to kitchen

- ✓ Ideal Logic Combination boiler (in boiler cupboard)
- ✓ Family bathroom with shower above bath, shower screen
- ✓ Full height tiling around bath
- ✓ Vinyl flooring to WC and bathroom

- ✓ Roxby – upstairs and ground floor storage areas
- ✓ Whitby – upstairs storage area



The Roxby

In Phase One, we are delighted to offer two three bedroom end of terrace and one mid terrace. More three bedroom, mid and end terrace and semi detached coming late 19, mid 20.



You can register your interest for all our shared ownership homes to be built from now until June 2021. See our website for more details and to register your interest. www.prospahomes.co.uk



The Whitby

In Phase one, delighted to offer one two bedroom end of terrace home. More two bedroom end of and mid terrace homes coming in June 20.



You can register your interest for all our shared ownership homes to be built from now until June 2021. See our website for more details and to register your interest. www.prospahomes.co.uk

Get a place of your own through shared ownership



Shared ownership is a government backed home ownership option for people struggling to get a foot on the housing ladder.

Eligible households can include first time buyers, such as those renting or living with family, existing shared owners and home owners selling because of a relationship breakdown.

Shared ownership allows the purchaser to buy a share of a property, paying a reduced rent on the share you don't own.* The bigger the share you buy the less rent you pay.

Shared owners can buy a greater share at any time, including up to 100% at which point they stop paying rent.

People find shared ownership can be more affordable than renting privately and typically enables buying a home with a much lower deposit and mortgage than if buying outright.

Please check out our shared ownership guide for more information on how shared ownership works. Email us on sales@prospahomes.co.uk or call **01606 813319** to discuss and ask any questions.

To apply for shared ownership visit www.helptobuynw.org.uk



Find out more and download our about shared ownership guide: www.prospahomes.co.uk



Talk to us:

Email us on sales@prospahomes.co.uk or call **01606 813319** to discuss and ask any questions.

Find out if you're eligible for shared ownership.

Help to Buy North West is the online government backed portal that assesses whether people are eligible for shared ownership. To apply online is free and does not commit you to anything. See if you're eligible visit www.helptobuynw.org.uk and select Dane View as your preferred development.

*Remember if you don't keep up rent and mortgage payments you may lose your home.

The Roxby

3 Bedroom Home

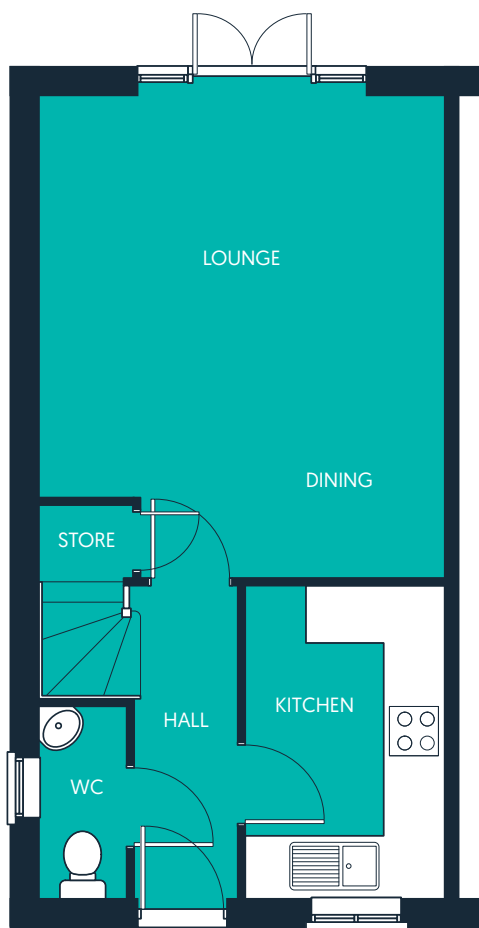

Ground Floor Plan

Loung/Dinning: 4.25m x 5.60m*

Kitchen: 2.09m x 3.25m*

WC: 0.93m x 1.99m*

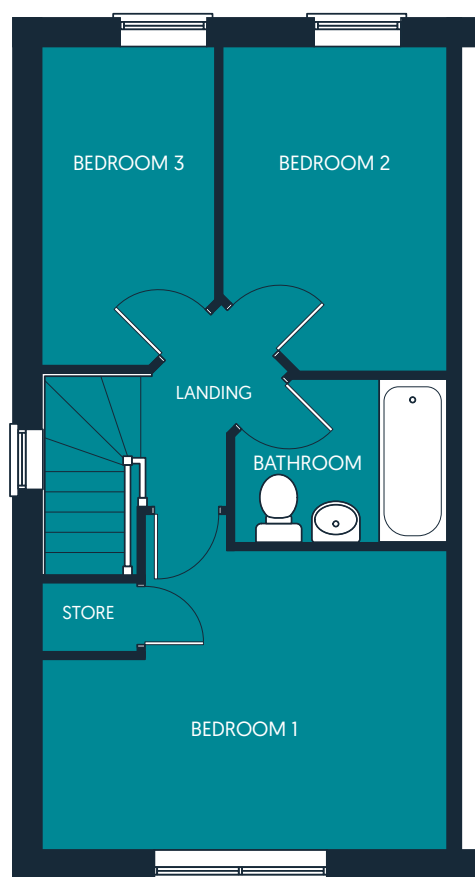

First Floor Plan

Bedroom 1: 4.25m x 3.52m*

Bedroom 2: 2.36m x 3.38m*

Bedroom 3: 1.82m x 3.30m*

Bathroom: 2.23m x 1.72m*



Floor plans and images are for illustrative purposes. Layouts will vary depending on orientation on the site. *Sizes are approximate only, purchasers should take your own measurements before ordering flooring, furniture, fixtures and fittings.

The Whitby

2 Bedroom Home

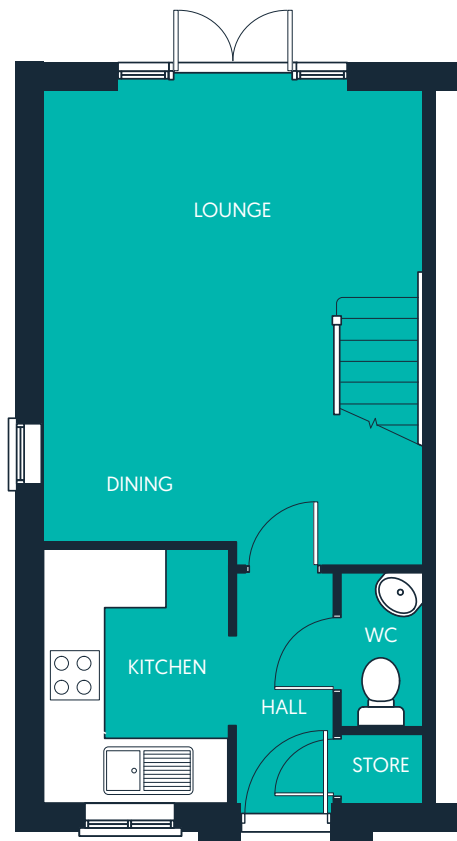

Ground Floor Plan

Loung/Dinning: 3.99m x 4.98m*

Kitchen: 1.96m x 2.70m*

WC: 0.90m x 1.62m*

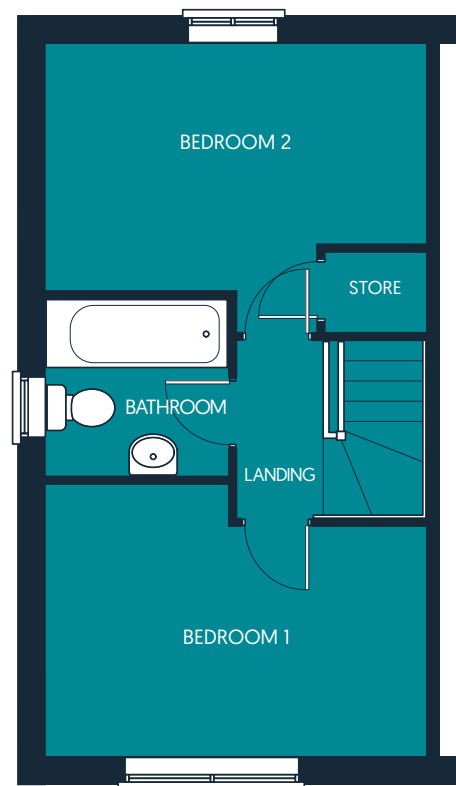

First Floor Plan

Bedroom 1: 3.99m x 2.87m*

Bedroom 2: 3.99m x 3.04m*

Bathroom: 1.91m x 1.87m*



Floor plans and images are for illustrative purposes. Layouts will vary depending on orientation on the site. *Sizes are approximate only, purchasers should take your own measurements before ordering flooring, furniture, fixtures and fittings.

CONTACT US
AND FIND OUT
MORE



**Shipbrook Road, Rudheath,
Cheshire CW9 7HF**

Email: **sales@prospahomes.co.uk**

Call: **01606 813 319**

Web: **www.prospahomes.co.uk**





Dane View

Shipbrook Road, Rudheath, Cheshire CW9 7HF

E: sales@prospahomes.co.uk **T:** 01606 813319 **W:** www.prospahomes.co.uk

Prospa Homes / Gadbrook Point / Rudheath Way / Northwich / Cheshire / CW9 7LL

Weaver Vale Housing Trust Limited is a charitable Community Benefit Society registered under the Co-operative and Community Benefit Societies Act 2014.